

SQUARE FOOTAGE	
HEATED FLOOR	1,738 SQ.FT.
BONUS ROOM	448 SQ.FT.
GARAGE	469 SQ.FT.
PORCHES	133 SQ.FT.
<b>TOTAL</b>	<b>2,788 SQ.FT.</b>

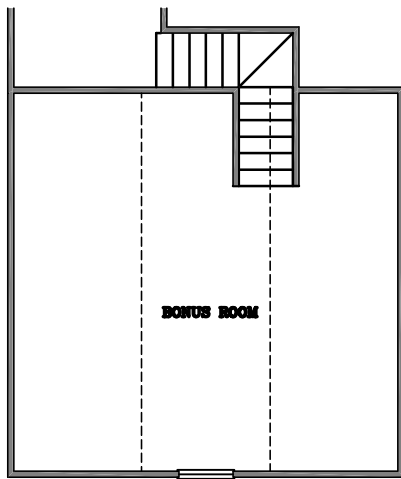

**BONUS ROOM**  
SCALE: 3/32" = 1'-0"

**FLOOR PLAN**  
SCALE: 1/8" = 1'-0"

<b>A2</b>	DRAWING NUMBER	1
	FLOOR PLAN	
	DATE	05/04/18
	DRAWN BY	MSW

**THE MELISSA PLAN**  
A NEW HOUSE FOR  
**SOLID ROCK HOLDINGS LLC**  
SATILLA SANDS SUBDIVISION  
BRUNSWICK, GEORGIA

Drawings Prepared for:

---

Drawings Prepared By:  
**Malcolm S. Williamson**  
103 Palm Club Circle  
Brunswick, Georgia 32525  
C: 912-222-4740  
malcolmsw@gmail.com

**DISCLAIMER:**  
THESE DRAWINGS ARE INTENDED TO SERVE AS DIMENSIONED ILLUSTRATIONS OF OWNER'S INSTRUCTIONS TO THE PRIME CONTRACTOR. PRIME CONTRACTOR TO BE RESPONSIBLE FOR VERIFICATION AND IMPLEMENTATION OF ALL CODES, QUALITY OF MATERIALS AND THEIR INSTALLATION AND STRUCTURAL INTEGRITIES. MALCOLM S. WILLIAMSON WILL BE HELD HARMLESS BY OWNER, PRIME AND SUB CONTRACTORS FOR ALL LIABILITIES THAT MAY ARISE FROM THIS PROJECT INCLUDING BUT NOT LIMITED TO: CODE VIOLATIONS FOR COMPLIANCE, VIOLATION OF ACCEPTED PRACTICES OF MATERIAL QUALITY OR INSTALLATION AND/OR INFERIOR CONSTRUCTION PRACTICES ASSOCIATED WITH THIS PROJECT.